

Belmar Municipal Road and Utilities Capital Improvement Plan

PREPARED FOR

The Borough of Belmar
MONMOUTH COUNTY
601 MAIN STREET
BELMAR, NJ 07719

PREPARED BY

REMINGTON & VERNICK
ENGINEERS
9 ALLEN STREET
TOMS RIVER, NJ 08753
(732) 286-9220

October 2023

RVE Project No. 1307U001

Borough of Belmar

Municipal Roads and Utilities Study

June 2023

Executive Summary:

Remington & Vernick Engineers has performed an investigation of the roads and utilities (water, sewer and drainage) in the Borough and come up with a rating for each road based on condition of road, sanitary sewer and water as well as need for additional drainage to be added. From our investigation we have found that there are many areas that are showing signs of aging and deterioration that will need to be addressed in the near future in order to keep the Borough infrastructure functioning and reducing the emergency repairs required. Due to the size of the Borough, our office evaluated the roads in two block sections.

Roads were evaluated giving equal weight to pavement condition, water main and later condition, sewer main and lateral condition and drainage condition. Utilities were rated from 1 to 4 with 4 being in need of immediate replacement and 1 being recently paved. Utilities (water and sanitary sewer) were either given a 1 or a 4. If they were noted in previous reports as requiring replacement, they were given a 4, if not they were given a 1. The drainage was also based on the overall map and given a 4 (needing drainage improvements) or a 1 (not needing drainage improvements). The results were tallied up and a list of priorities was created based on the scoring of each road. The maximum score for a road would be 16 (4 for pavement, 4 each for water and sewer and 4 for drainage for a total of 16). In addition, costs were added to each section of roadway that includes required pavement and utility costs required to complete the work. The complete evaluation is attached to this study.

The following are the top 20 results of the evaluation:

	Roadway	From	To	Points	Cost	Required
1	Eleventh	B	D	14	\$495,000.00	RWSD
2	Fourth	Ocean	B	12	\$575,000.00	RWD No S
3	Eighth	Ocean	B	12	\$415,000.00	RSD No W
4	B	Fifteenth	Eighteenth	12	\$420,000.00	RWD No S
5	River	B	Fifth	12	\$865,000.00	RWD No S
6	Third	B	River	12	\$465,000.00	RWD No S
7	Fifth	D	Main	12	\$375,000.00	RWD No S
8	Seventh	N. Lake	Main	12	\$700,000.00	RWD No S
9	Thirteenth	Main	Rte. 71	12	\$670,000.00	RWD No S
10	L	Rte. 35	Sixteenth	12	\$560,000.00	RWD No S
11	Ninth	Ocean	B	11	\$615,000.00	RWS No D

12	Tenth	Ocean	B	11	\$590,000.00	RWD No S
13	Fifth	B	D	11	\$585,000.00	RWD No S
14	Ninth	B	D	11	\$415,000.00	RWD No S
15	Tenth	B	D	11	\$440,000.00	RWS No D
16	D	Fourth	Sixteenth	11	\$1,790,000.00	RWD No S
17	E	Fifth	Seventh	11	\$380,000.00	RWS No D
18	Maplewood	Rte. 35	Sixteenth	11	\$385,000.00	RWD No S
19	Second	Ocean	B	10	\$585,000.00	RWD No S
20	Eleventh	Ocean	B	10	\$695,000.00	RWS No D
21	B	First	N Lake	10	\$810,000.00	RWD No S
22	Eleventh	D	Main	10	\$545,000.00	RWD No S
23	Terrace	Fifth	Terminus	10	\$720,000.00	RWS No D
24	Third	Ocean	B	8	\$585,000.00	RW No DS

R = Road, W = Water, S = Sewer, D = Drainage

Per the above, the top 10 all have at least 12 points and should be top priorities. It should be noted that all projects that scored above a 10 should be considered eligible for consideration at this time. It should also be noted that, although some areas scored lower, there may be some areas that drainage, sanitary sewer or water lines will need to be replaced sooner. The total of the top ten project comes to \$5,540,000.00 and could be paid through sanitary sewer, water as well as road and drainage funds. To take us down to a score of 10, there would be an additional \$8,555,000.00 in funding required bringing the highest priority road and utility work required to \$14,000,000.00. Assuming \$1,000,000.00 a year allocated by the Borough and an additional \$300k provided by NJDOT and other sources, it would take approximately 10 years to complete. It may be advantageous to consider lumping several years together and requesting a loan from the NJEIT (New Jersey Environmental Infrastructure Trust) as they provide low cost loans for larger projects and sometimes provide principal forgiveness for water and sewer work. In addition, the Borough should start preparing applications for NJDOT project to coincide with water and sewer work.

At this time, the Borough has been awarded \$274,290.00 in funding for the 2023 NJDOT Local Aid Transportation Trust fund for Fifth Avenue from Main to C Street. Per the above, Fifth from Main to D is in the top 10 and Fifth from B to D is number tied for 11th. The cost for construction comes to \$375,000 + \$300,000.00 (1/2 of B to D) for a total project cost of \$675,000.00. After the award, the work would cost approximately \$400,000.00. Additionally, our office would require \$75,000.00 (20%) for design, bidding, contract administration and observation bringing the Borough portion of the project to \$475,000.00.

A meeting should be held by the Borough to gain input from the water, sewer and finance departments to get a better understanding of road priorities and funding options.

Scale	Road Condition	Storm Sewer	Water Main	Sanitary Sewer
Good or New	1			
Fair	2	2	2	2
Poor	3	3	3	3
Bad	4	4	4	4
Outlined on plan		1	1	1
Not outlined	0	0	0	0

don't move out of abc order

Road Name	From	To	Road Condition	Storm Sewer	Water Main	Sanitary Sewer	SUM
A St	Sixth Ave	Twentieth Ave	3	0	3	4	10
A St	First Ave	Fifth Ave	1	0	0	0	1
B St	Fifteenth ave	Eighteenth Ave	4	1	3	0	8
B St	Seventh Ave	Fifteenth	2	2	3	0	7
B St	first ave	North Lake Drive	2	2	2	0	6
B St	Eighteenth	North Blvd	3	0	0	0	3
Briarwood Road	Sixteenth Ave	Route 35	2	0	1	4	7
C St	Thirteenth Ave	Sixteenth Ave	3	0	0	0	3
C St	Third Ave	North Lake Drive	2	0	0	0	2
C St	Eighth Ave	Twelfth Ave	2	0	0	0	2
D St	River Ave	Sixteenth Ave	3	2	3	3	11
E St	Fifth Ave	Sixteenth Ave	3	2	2	2	9
East Railroad	Thirteenth Ave	Twelfth Ave	4	0	0	0	4
East Railroad	Sixteenth Ave	Thirteenth	1	0	0	0	1
Eighteenth Ave	B St	Ocean Ave	2	0	0	2	4
Eighth Ave	Main St	Ocean Ave	4	2	3	4	13
Eighth Ave	Route 35	Main St	1	0	3	0	4
Eleventh Ave	Main St	Ocean Ave	2	3	4	4	13
Eleventh Ave	Route 35	Main St	2	1	1	0	4
Fifteenth Ave	Main St	Ocean Ave	1	0	2	2	5
Fifteenth Ave	East Railroad	Main St	1	0	0	0	1
Fifth Ave	Main St	Ocean Ave	3	2	3	0	8
First Ave	B St	Ocean Ave	2	0	2	0	4
Fourteenth Ave	E St	Ocean Ave	4	0	4	0	8
Fourteenth Ave	L st	K St	3	0	3	0	6
Fourth Ave	River Ave	Ocean Ave	4	2	3	0	9
H St	Sixteenth Ave	Route 35	0	2	3	0	5
inlet terrace	fifth ave	end	2	0	0	2	4
K St	Fourteenth Ave	Route 35	4	0	3	3	10
L st	Sixteenth Ave	Route 35	4	4	3	0	11
Main St	Sixteenth Ave	Fifth Ave	0	2	4	3	9
Maplewood Road	Sixteenth Ave	Route 35	3	3	4	2	12
Marina Ave	K st	Seventh Ave	2	0	0	0	2
Nineteenth Ave	B St	Ocean Ave	1	2	0	2	5
Ninth Ave	Main St	Ocean Ave	3	3	3	3	12
North Blvd	B St	Ocean Ave	2	0	0	0	2

Scale	Road Condition	Storm Sewer	Water Main	Sanitary Sewer
Good or New	1			
Fair	2	2	2	2
Poor	3	3	3	3
Bad	4	4	4	4
Outlined on plan		1	1	1
Not outlined	0	0	0	0

	Road Name	From	To	Road Condition	Storm Sewer	Water Main	Sanitary Sewer	SUM
	North Lake Drive	Eighth Ave	Fifth Ave	3	0	3	0	6
	Oakwood Rd	Sixteenth Ave	Route 35	2	0	4	0	6
	Pine Tree Way	Sixteenth Ave	Route 35	2	0	4	3	9
	River Ave	First Ave	Second Ave	2	3	2	0	7
	River Ave	Second Ave	Fifth Ave	4	2	0	0	6
	River Ave	Sixth Ave	Seventh Ave	2	0	0	0	2
	River Ave	First Ave	Ocean Ave	2	0	2	0	4
	River Court	Sixteenth Ave	End	1	0	1	4	6
	River Rd	Sixth Ave	Fifth Ave	2	0	0	0	2
	riverview Terrace	Borough Limits	Sixteenth Ave	1	0	2	0	3
	Rosewood Drive	Borough Limits	Sixteenth Ave	1	0	2	0	3
	Route 35	Sixteenth Ave	H st	0	0	4	2	6
	Route 35	h st	sixth ave	0	2	4	0	6
	Second Ave	B St	Ocean Ave	2	2	2	0	6
	Seventeenth Ave	B St	Ocean Ave	1	0	0	2	3
	Seventh Ave	Main St	N Lake Drive	4	2	3	4	13
	Seventh Ave	River Ave	main St	2	0	3	0	5
	Seventh Ave	B St	Ocean Ave	1	0	0	0	1
	Sixteenth Ave	Main St	Ocean Ave	0	2	3	3	8
	Sixteenth Ave	Route 35	main St	0	0	3	3	6
	Sixth Ave	Main St	N Lake Drive	3	0	4	3	10
	Sixth Ave	S Lake Drive	Ocean Ave	3	2	2	0	7
	Sixth Ave	River Rd	main St	2	0	3	0	5
	Snyder Ave	Seventeeth	North Blvd	2	0	0	4	6
	South Lake Drive	A St	B St	3	2	2	0	7
	Surf Ave	Seventeeth St	North Blvd	1	0	0	2	3
	Tenth Ave	Main St	Ocean Ave	3	2	3	3	11
	Tenth Ave	Route 35	Main St	2	0	3	0	5
	Third Ave	River Ave	Ocean Ave	4	3	3	0	10
	Thirteenth Ave	L st	H St	4	2	3	0	9
	Thirteenth Ave	H St	main St	4	1	3	0	8
	Thirteenth Ave	Main St	Ocean Ave	2	2	0	0	4
	Twelfth Ave	Route 35	main St	1	0	0	3	4
	Twelfth Ave	Main St	Ocean Ave	1	0	0	0	1
	Twentieth Ave	A St	Ocean Ave	1	0	0	0	1
	West Railroad	Sixteenth Ave	Twelfth Ave	1	0	0	0	1

Scale	Road Condition	Storm Sewer	Water Main	Sanitary Sewer
Good or New	1			
Fair	2	2	2	2
Poor	3	3	3	3
Bad	4	4	4	4
Outlined on plan		1	1	1
Not outlined	0	0	0	0

Road Name	From	To	Road Condition	Storm Sewer	Water Main	Sanitary Sewer	SUM
West Railroad Ave	Eighth Ave	Seventh Ave	4	0	0	0	4
West Railroad Ave	Twelfth Ave	Eighth Ave	3	0	0	0	3

D St	main St
Fifth Ave	Sixteenth Ave

Main St	Route No 71
Fifth Ave	Sixteenth Ave

Scale	Road Condition	Storm Sewer	Water Main	Sanitary Sewer
Good or New	1			
Fair	2	2		2
Poor	3	3		3
Bad	4	4		4
Outlined on plan		1		1
Not outlined	0	0		0

Road Name	From	To	Road Condition	Storm Sewer	Water Main	Sanitary Sewer	SUM
Route No 71 Highway Route No 35							
Highway Route No 35 Sixteenth Ave							

Roads are split main street to east/west

Scale	Road Condition	Storm Sewer	Water Main	Sanitary Sewer
Good or New	1			
Fair	2	2	2	2
Poor	3	3	3	3
Bad	4	4	4	4
Outlined on plan		1	1	1
Not outlined		0	0	0

PRIORITY	Road Name	From	To	Road Condition	Approx. Road Cost	Storm Sewer	Approx. Storm Cost	Water Main	Approx. Water Cost	Sanitary Sewer	Approx. Sanitary Cost	SUM	Total Approx. Cost	Recently Paved
1	Eighth Ave	Main St	Ocean Ave	4	\$ 540,000.00	2	\$ 60,000.00	3	\$ 480,000.00	4	\$ -	13	\$ 1,080,000.00	no
	Eleventh Ave	Main St	Ocean Ave	2	\$ 540,000.00	3	\$ 120,000.00	4	\$ 480,000.00	4	\$ 440,000.00	13	\$ 1,580,000.00	yes
2	Seventh Ave	Main St	N Lake Drive	4	\$ 225,000.00	2	\$ 75,000.00	3	\$ 200,000.00	4	\$ 100,000.00	13	\$ 600,000.00	no
7	Maplewood Road	Sixteenth Ave	Route 35	3	\$ 270,000.00	3	\$ 90,000.00	4	\$ 320,000.00	2	\$ 120,000.00	12	\$ 800,000.00	no
3	Ninth Ave	Main St	Ocean Ave	3	\$ 540,000.00	3	\$ 120,000.00	3	\$ 240,000.00	3	\$ 120,000.00	12	\$ 1,020,000.00	no
6	D St	River Ave	Sixteenth Ave	3	\$ 990,000.00	2	\$ 300,000.00	3	\$ 800,000.00	3	\$ -	11	\$ 2,090,000.00	no
	L st	Sixteenth Ave	Route 35	4	\$ 360,000.00	4	\$ 120,000.00	3	\$ 320,000.00	0	\$ 240,000.00	11	\$ 1,040,000.00	no
4	Tenth Ave	Main St	Ocean Ave	3	\$ 540,000.00	2	\$ 60,000.00	3	\$ 480,000.00	3	\$ 120,000.00	11	\$ 1,200,000.00	no
	A St	Sixth Ave	Twentieth Ave	3	\$ 1,260,000.00	0	\$ 150,000.00	3	\$ 800,000.00	4	\$ 80,000.00	10	\$ 2,290,000.00	no
	K St	Fourteenth Ave	Route 35	4	\$ 180,000.00	0	\$ -	3	\$ 160,000.00	3	\$ -	10	\$ 340,000.00	no
8	Sixth Ave	Main St	N Lake Drive	3	\$ 270,000.00	0	\$ -	4	\$ 240,000.00	3	\$ -	10	\$ 510,000.00	no
	Third Ave	River Ave	Ocean Ave	4	\$ 360,000.00	3	\$ 60,000.00	3	\$ 320,000.00	0	\$ 40,000.00	10	\$ 780,000.00	no
	E St	Fifth Ave	Sixteenth Ave	3	\$ 900,000.00	2	\$ 30,000.00	2	\$ 800,000.00	2	\$ -	9	\$ 1,730,000.00	no
	Fourth Ave	River Ave	Ocean Ave	4	\$ 360,000.00	2	\$ 60,000.00	3	\$ 320,000.00	0	\$ -	9	\$ 740,000.00	no
5	Main St	Sixteenth Ave	Fifth Ave	0	\$ 900,000.00	2	\$ 300,000.00	4	\$ 800,000.00	3	\$ -	9	\$ 2,000,000.00	unknown
	Pine Tree Way	Sixteenth Ave	Route 35	2	\$ 360,000.00	0	\$ -	4	\$ 320,000.00	3	\$ -	9	\$ 680,000.00	yes
	Thirteenth Ave	H St	main St	4	\$ 270,000.00	2	\$ 90,000.00	3	\$ 240,000.00	0	\$ -	9	\$ 600,000.00	no
	B St	Fifteenth Ave	Eighteenth Ave	4	\$ 270,000.00	1	\$ -	3	\$ 240,000.00	0	\$ -	8	\$ 510,000.00	no
	Fifth Ave	Main St	Ocean Ave	3	\$ 540,000.00	2	\$ 90,000.00	3	\$ 480,000.00	0	\$ 40,000.00	8	\$ 1,150,000.00	no
	Fourteenth Ave	E St	Ocean Ave	4	\$ 450,000.00	0	\$ -	4	\$ 400,000.00	0	\$ -	8	\$ 850,000.00	no
	Sixteenth Ave	Main St	Ocean Ave	0	\$ 540,000.00	2	\$ 60,000.00	3	\$ 480,000.00	3	\$ -	8	\$ 1,080,000.00	unknown
	Thirteenth Ave	L st	H St	4	\$ 180,000.00	1	\$ -	3	\$ 160,000.00	0	\$ 240,000.00	8	\$ 580,000.00	no
	B St	Seventh Ave	Fifteenth Ave	2	\$ 720,000.00	2	\$ 270,000.00	3	\$ 720,000.00	0	\$ -	7	\$ 1,710,000.00	yes
	Briarwood Road	Sixteenth Ave	Route 35	2	\$ 270,000.00	0	\$ -	1	\$ 240,000.00	4	\$ -	7	\$ 510,000.00	yes
	River Ave	First Ave	Second Ave	2	\$ 90,000.00	3	\$ 30,000.00	2	\$ 80,000.00	0	\$ -	7	\$ 200,000.00	yes
	Sixth Ave	S Lake Drive	Ocean Ave	3	\$ 90,000.00	2	\$ 30,000.00	2	\$ 80,000.00	0	\$ -	7	\$ 200,000.00	no
	South Lake Drive	A St	B St	3	\$ 90,000.00	2	\$ 30,000.00	2	\$ 80,000.00	0	\$ -	7	\$ 200,000.00	no
	B St	First Ave	North Lake Drive	2	\$ 450,000.00	2	\$ 150,000.00	2	\$ 400,000.00	0	\$ -	6	\$ 1,000,000.00	yes
	Fourteenth Ave	L st	K St	3	\$ 90,000.00	0	\$ -	3	\$ 80,000.00	0	\$ -	6	\$ 170,000.00	no
	North Lake Drive	Eighth Ave	Fifth Ave	3	\$ 270,000.00	0	\$ -	3	\$ 240,000.00	0	\$ -	6	\$ 510,000.00	no
	Oakwood Rd	Sixteenth Ave	Route 35	2	\$ 270,000.00	0	\$ -	4	\$ 240,000.00	0	\$ 240,000.00	6	\$ 750,000.00	yes
	River Ave	Second Ave	Fifth Ave	4	\$ 450,000.00	2	\$ 60,000.00	0	\$ -	0	\$ -	6	\$ 510,000.00	no
	River Court	Sixteenth Ave	End	1	\$ 180,000.00	0	\$ -	1	\$ 80,000.00	4	\$ -	6	\$ 260,000.00	yes
	Route 35	Sixteenth Ave	H st	0	\$ 990,000.00	0	\$ -	4	\$ 880,000.00	2	\$ -	6	\$ 1,870,000.00	unknown
	Route 35	h st	sixth ave	0	\$ 540,000.00	2	\$ 30,000.00	4	\$ 480,000.00	0	\$ 160,000.00	6	\$ 1,210,000.00	unknown
	Second Ave	B St	Ocean Ave	2	\$ 180,000.00	2	\$ 60,000.00	2	\$ 80,000.00	0	\$ -	6	\$ 320,000.00	yes
	Sixteenth Ave	Route 35	main St	0	\$ 1,170,000.00	0	\$ -	3	\$ 1,040,000.00	3	\$ -	6	\$ 2,210,000.00	unknown
	Snyder Ave	Seventeenth	North Blvd	2	\$ 270,000.00	0	\$ -	0	\$ -	4	\$ 80,000.00	6	\$ 350,000.00	yes
	Fifteenth Ave	Main St	Ocean Ave	1	\$ 540,000.00	0	\$ -	2	\$ 160,000.00	2	\$ -	5	\$ 700,000.00	yes
	H St	Sixteenth Ave	Route 35	0	\$ 450,000.00	2	\$ 150,000.00	3	\$ 400,000.00	0	\$ -	5	\$ 1,000,000.00	unknown
	Nineteenth Ave	B St	Ocean Ave	1	\$ 180,000.00	2	\$ 60,000.00	0	\$ -	2	\$ 80,000.00	5	\$ 320,000.00	yes
	Seventh Ave	River Ave	main St	2	\$ 90,000.00	0	\$ -	3	\$ 80,000.00	0	\$ -	5	\$ 170,000.00	yes
	Sixth Ave	River Rd	main St	2	\$ 90,000.00	0	\$ -	3	\$ 80,000.00	0	\$ 40,000.00	5	\$ 210,000.00	yes
	Tenth Ave	Route 35	Main St	2	\$ 180,000.00	0	\$ -	3	\$ 160,000.00	0	\$ 160,000.00	5	\$ 500,000.00	yes
	East Railroad	Thirteenth Ave	Twelfth Ave	4	\$ 900,000.00	0	\$ -	0	\$ -	0	\$ 440,000.00	4	\$ 1,340,000.00	no
	Eighteenth Ave	B St	Ocean Ave	2	\$ 270,000.00	0	\$ -	0	\$ -	2	\$ -	4	\$ 270,000.00	yes
	Eighth Ave	Route 35	Main St	1	\$ 90,000.00	0	\$ -	3	\$ 80,000.00	0	\$ -	4	\$ 170,000.00	yes
	Eleventh Ave	Route 35	Main St	2	\$ 90,000.00	1	\$ 30,000.00	1	\$ 80,000.00	0	\$ 40,000.00	4	\$ 240,000.00	yes

Roads are split main street to east/west

Scale	Road Condition	Storm Sewer	Water Main	Sanitary Sewer
Good or New	1			
Fair	2	2	2	2
Poor	3	3	3	3
Bad	4	4	4	4
Outlined on plan		1	1	1
Not outlined		0	0	0

PRIORITY	Road Name	From	To	Road Condition	Approx. Road Cost	Storm Sewer	Approx. Storm Cost	Water Main	Approx. Water Cost	Sanitary Sewer	Approx. Sanitary Cost	SUM	Total Approx. Cost	Recently Paved
	First Ave	B St	Ocean Ave	2	\$ 180,000.00	0	\$ -	2	\$ 160,000.00	0	\$ 240,000.00	4	\$ 580,000.00	yes
	inlet terrace	fifth ave	end	2	\$ 180,000.00	0	\$ -	0	\$ -	2	\$ 80,000.00	4	\$ 260,000.00	yes
	River Ave	First Ave	Ocean Ave	2	\$ 90,000.00	0	\$ -	2	\$ 80,000.00	0	\$ -	4	\$ 170,000.00	yes
	Thirteenth Ave	Main St	Ocean Ave	2	\$ 540,000.00	2	\$ 180,000.00	0	\$ -	0	\$ 40,000.00	4	\$ 760,000.00	yes
	Twelfth Ave	Route 35	main St	1	\$ 180,000.00	0	\$ -	0	\$ -	3	\$ -	4	\$ 180,000.00	yes
	West Railroad Ave	Eighth Ave	Seventh Ave	4	\$ 90,000.00	0	\$ -	0	\$ -	0	\$ -	4	\$ 90,000.00	no
	B St	Eighteenth	North Blvd	3	\$ 180,000.00	0	\$ -	0	\$ -	0	\$ -	3	\$ 180,000.00	no
	C St	Thirteenth Ave	Sixteenth Ave	3	\$ 270,000.00	0	\$ -	0	\$ 330,000.00	0	\$ 40,000.00	3	\$ 640,000.00	no
	riverview Terrace	Borough Limits	Sixteenth Ave	1	\$ 90,000.00	0	\$ -	2	\$ 80,000.00	0	\$ 240,000.00	3	\$ 410,000.00	yes
	Rosewood Drive	Borough Limits	Sixteenth Ave	1	\$ 90,000.00	0	\$ -	2	\$ 80,000.00	0	\$ -	3	\$ 170,000.00	yes
	Seventeenth Ave	B St	Ocean Ave	1	\$ 180,000.00	0	\$ -	0	\$ -	2	\$ -	3	\$ 180,000.00	yes
	Surf Ave	Seventeenth St	North Blvd	1	\$ 270,000.00	0	\$ -	0	\$ -	2	\$ 400,000.00	3	\$ 670,000.00	yes
	West Railroad Ave	Twelfth Ave	Eighth Ave	3	\$ 360,000.00	0	\$ -	0	\$ -	0	\$ -	3	\$ 360,000.00	no
	C St	Eighth Ave	Twelfth Ave	2	\$ 360,000.00	0	\$ -	0	\$ -	0	\$ 40,000.00	2	\$ 400,000.00	yes
	C St	Third Ave	North Lake Drive	2	\$ 270,000.00	0	\$ -	0	\$ -	0	\$ -	2	\$ 270,000.00	yes
	Marina Ave	K st	Seventh Ave	2	\$ 540,000.00	0	\$ -	0	\$ -	0	\$ 40,000.00	2	\$ 580,000.00	yes
	North Blvd	B St	Ocean Ave	2	\$ 180,000.00	0	\$ -	0	\$ -	0	\$ -	2	\$ 180,000.00	yes
	River Ave	Sixth Ave	Seventh Ave	2	\$ 90,000.00	0	\$ -	0	\$ -	0	\$ 40,000.00	2	\$ 130,000.00	yes
	River Rd	Sixth Ave	Fifth Ave	2	\$ 90,000.00	0	\$ -	0	\$ -	0	\$ -	2	\$ 90,000.00	yes
	A St	First Ave	Fifth Ave	1	\$ 450,000.00	0	\$ -	0	\$ -	0	\$ -	1	\$ 450,000.00	yes
	East Railroad	Sixteenth Ave	Thirteenth	1	\$ 180,000.00	0	\$ -	0	\$ -	0	\$ -	1	\$ 180,000.00	yes
	Fifteenth Ave	East Railroad	Main St	1	\$ 90,000.00	0	\$ -	0	\$ -	0	\$ -	1	\$ 90,000.00	yes
	Seventh Ave	B St	Ocean Ave	1	\$ 180,000.00	0	\$ -	0	\$ -	0	\$ -	1	\$ 180,000.00	yes
	Twelfth Ave	Main St	Ocean Ave	1	\$ 540,000.00	0	\$ -	0	\$ -	0	\$ -	1	\$ 540,000.00	yes
	Twentieth Ave	A St	Ocean Ave	1	\$ 90,000.00	0	\$ -	0	\$ -	0	\$ -	1	\$ 90,000.00	yes
	West Railroad	Sixteenth Ave	Twelfth Ave	1	\$ 270,000.00	0	\$ -	0	\$ -	0	\$ -	1	\$ 270,000.00	yes

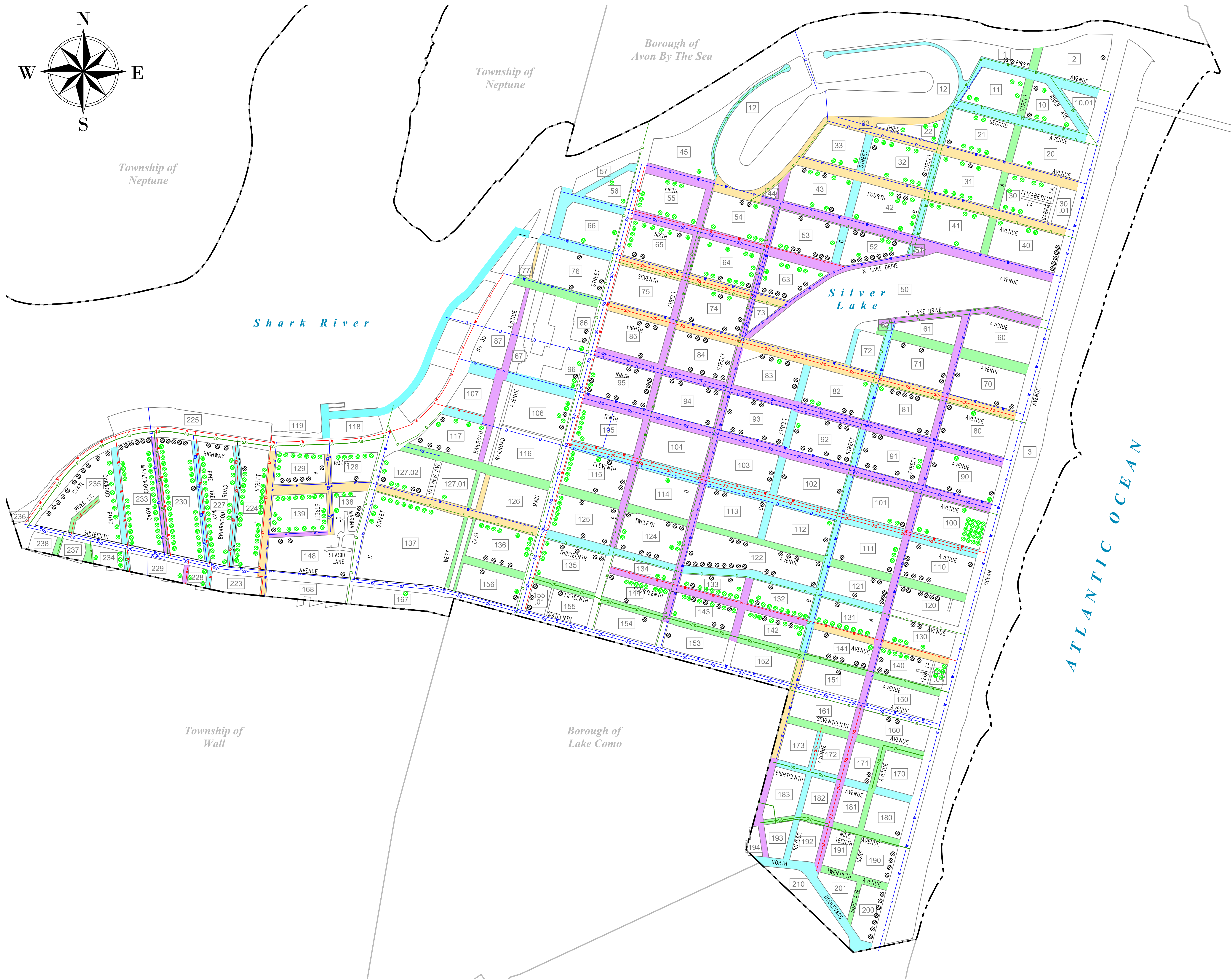
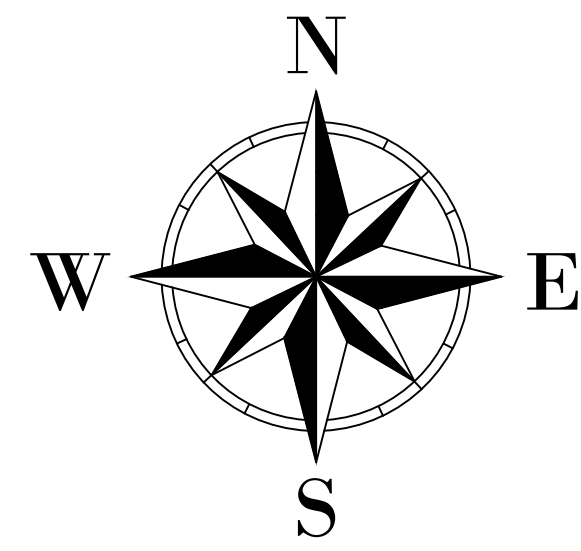

UTILITY PRIORITY LIST

- HIGH PRIORITY
- MEDIUM PRIORITY
- LOW PRIORITY

LEGEND

- Road Condition, Good or New
- Road Condition, Fair
- Road Condition, Poor
- Road Condition, Bad
- Storm Sewer
- Water Mains
- Sanitary Mains
- Borough Boundary
- # Block Number
- ⊙ Areas of Potential Lead Service
- ⊙ Areas of Galvanized Service

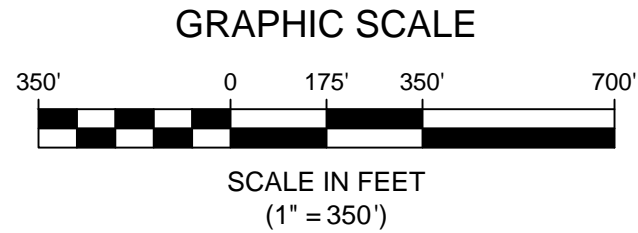

BOROUGH OF BELMAR

ROAD CONDITION MAP

Monmouth County New Jersey
12-12-2023 Scale: 1" = 350'

RVE **REMINGTON & VERNICK ENGINEERS**
9 ALLEN STREET, TOMS RIVER, NJ 08753
(732) 286-9220, FAX (732) 505-8416, WWW.RVE.COM
Certificate of Authorization: 24 GA 3893330
Excellence • Innovation • Service